

## DATA SHEET

### HSK 220 Thermal Store for DHW heating



#### Main Features

Description	A thermal store designed for continuous DHW heating in an integrated stainless-steel heat exchanger. It can be easily placed under RegulusBOX.
Working fluid	Water (DHW heat exchanger), water, water/glycol mixture (max. 1:1) or water/glycerine mixture (max. 2:1) (thermal store).

#### Code

Thermal Store	<b>19617</b>
Insulation	<b>19619</b>

#### Energy Efficiency Data (as per EC Regulation No. 812/2013)

<b>HSK 220 with insulation</b>	
Energy efficiency class	B
Standing loss	62 W
Storage volume	222 l

#### Technical Data

Total tank volume	222 l
Fluid volume in tank	201 l
DHW heat exchanger volume	21 l
DHW heat exchanger surface area	6 m <sup>2</sup>
Max. working temperature in Thermal Store	95 °C
Max. working temperature in DHW HX	95 °C
Max. working pressure in Thermal Store	4 bar
Max. working pressure in DHW HX	10 bar

#### Tank Materials

Tank material	S235JR
DHW heat exchanger material	AISI 316 L

#### Insulation Materials

Tank perimeter insulation	fleece
Tank perimeter insulation outer surface	hard polystyrene
Top tank insulation	polystyrene + fleece
Bottom insulation	fleece

#### Dimensions, Tipping height, Insulation thickness, Weight

Tank diameter	550 mm
Tank diameter with insulation	710 mm
Tank overall height	1105 mm
Tipping height without insulation	1152 mm
Tank perimeter insulation thickness	100 mm
Bottom insulation thickness	50 mm
Top insulation thickness	50 mm
Empty weight without insulation	60 kg

## DATA SHEET

### HSK 220 Thermal Store for DHW heating

#### Volume of supplied DHW (heated from 10 °C to 40 °C)

Heated volume	entire			entire			entire			entire		
Temperature in tank	50 °C			50 °C			60 °C			60 °C		
Backup heater	10 kW			none			10 kW			none		
Flow rate [l/min]	8	12	20	8	12	20	8	12	20	8	12	20
Hot water volume [l]	144	129	114	138	110	98	286	236	205	233	226	176

#### DHW heat exchanger pressure drop graph

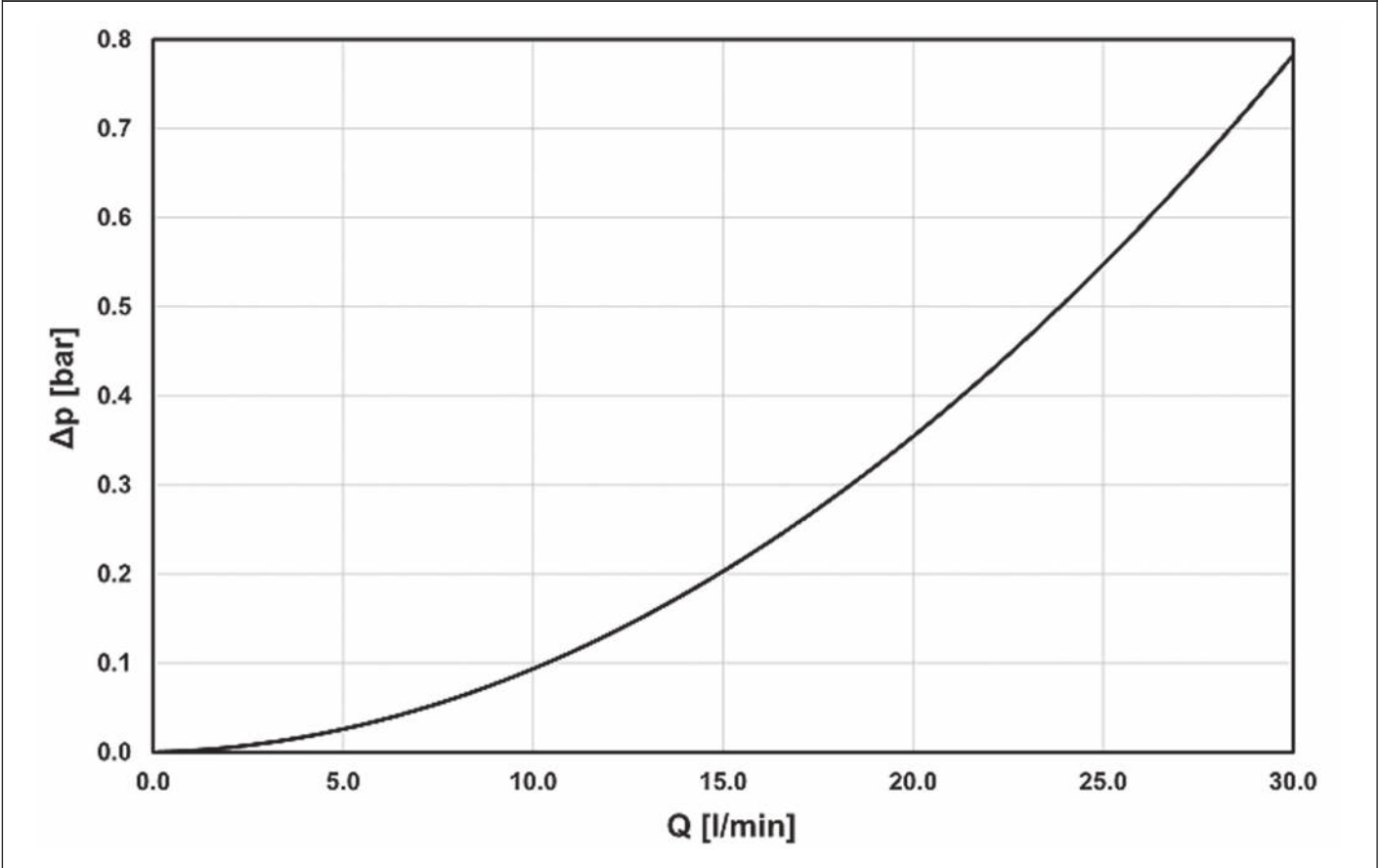

## DATA SHEET

### HSK 220 Thermal Store for DHW heating

#### Dimensions

Tipping height without insulation 1152 mm

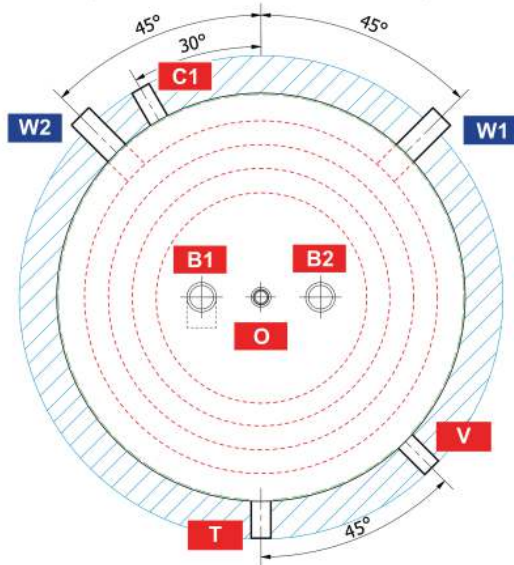
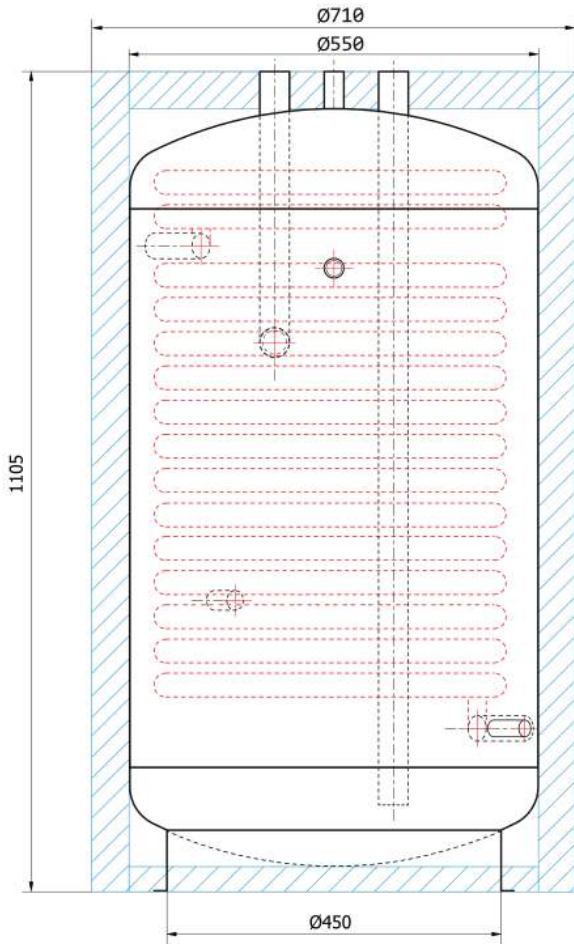

#### CONNECTIONS

pos.	description	connec- tion	height [mm]
<b>Heat sources</b>			
<b>B1</b>	Incoming from heat source	G 1" F	1105
<b>B2</b>	Return to heat source	G 1" F	1105
<b>DHW heating</b>			
<b>W1</b>	Cold water	G 1" M	220
<b>W2</b>	Hot water	G 1" M	870
<b>Control and safety</b>			
<b>C1</b>	Temperature sensor	G 1/2" F	390
<b>T</b>	Thermometer	G 1/2" F	840
<b>V</b>	Drain valve	G 1/2" F	220
<b>Air release</b>			
<b>O</b>	Air vent valve	G 1/2" F	1105